

ADDENDUM NO. 1

July 9, 2019

125685

RE: ORANGE SOUTHWEST SCHOOL DISTRICT, RANDOLPH, VERMONT
RANDOLPH UNION HIGH SCHOOL LOADING DOCK AND PAVEMENT REDEVELOPMENT

FROM: DuBOIS & KING, INC.
28 North Main Street
Randolph, Vermont 05060
(802) 728-3376

TO: Prospective Bidders

This Addendum forms part of the Contract Documents by the Orange Southwest School District for the Randolph Union High School Loading Dock and Pavement Redevelopment Project. Acknowledge receipt of this Addendum in the proposal. Failure to do so will subject the Bidder to disqualification.

I. Pre-Bid Meeting

A Pre-Bid meeting was held at the Project Site on July 8, 2019 at 10:00 a.m. Attendees are listed on the attached Pre-Bid Meeting Attendance Log (Attachment A). Christopher J. Rivet, P.E., of DuBois & King, Inc. described key elements of the project. The following addresses questions received at the pre-bid meeting and additional information and clarifications.

II. Bid Plans

Attached is a revised Sheet C-2, Proposed Conditions Plan, to include an additional area of new pavement; and supersedes Sheet C-2 provided in the Bid Plan Set (Attachment B).

Also, attached is a Parking Layout Plan for the striping work in the parking area (Attachment C).

III. Questions & Answers

Question 1: Should any excess soils be left on the school property, if it appears to be suitable for other uses, or will soils need to be removed off-site?

Answer 1: All excess soils shall be removed and properly disposed of off-site.

Question 2: Is shoulder work needed for the edges of the parking area?

Answer 2: Yes, shoulder work should be included for the parking area. Topsoil should be used to bring grassed areas flush with new pavement as needed.

Question 3: Will the pavement surrounding the bollards in the parking lot need to be removed and replaced?

Answer 3: Yes, the pavement will need to be removed and replaced around existing bollards.

ADDENDUM NO. 1

July 9, 2019

Page 2 of 2

Question 4: Will the parking lot striping include centerlines or directional arrows?

Answer 4: Parking lot striping will include the installation of directional arrows on the pavement. A detail is provided on the attached Parking Layout Plan.

IV. Additional Information/Clarifications

- a. Additional communications should go through Christopher Rivet (crivet@dubois-king.com).

This document constitutes Addendum 1 for this project.

**NOT FOR
CONSTRUCTION
BID PLANS**

NOTES:

- SEE SHEET 3 FOR ADDITIONAL NOTES AND LEGEND INFORMATION.

LEGEND:

- 645 --- 5-FOOT LIDAR CONTOUR
- 644 --- 1-FOOT LIDAR CONTOUR
- APPROXIMATE EXISTING EDGE OF BUILDING
- - - APPROXIMATE EXISTING EDGE OF PAVEMENT
- [Grid Pattern] PROPOSED PAVEMENT RESURFACING BOUNDARY
- [Diagonal Hatching] PROPOSED NEW PAVEMENT
- [Cross-hatching] PROPOSED PAVEMENT REMOVAL
- PROPOSED PAVEMENT SLOPE DIRECTION
- [Square] — PROPOSED SILT FENCE
- APPROXIMATE EXISTING EDGE OF ROAD

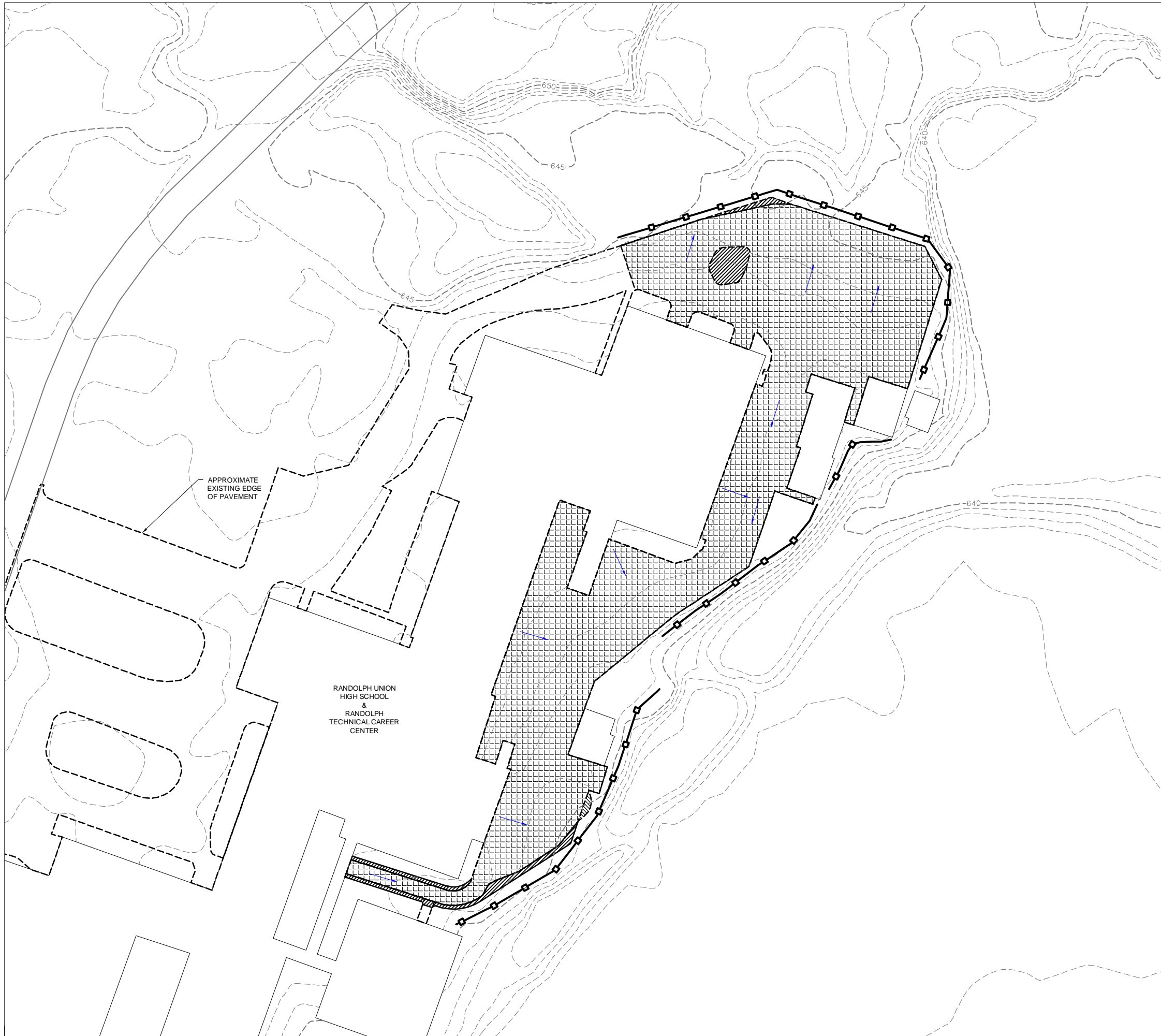

APPROXIMATE
EXISTING EDGE
OF PAVEMENT

RANDOLPH UNION
HIGH SCHOOL
&
RANDOLPH
TECHNICAL CAREER
CENTER



NO.	DATE	DESCRIPTION	BY	C/D

ORANGE
SOUTHWEST
SCHOOL DISTRICT
24 CENTRAL STREET
RANDOLPH, VT 05060

RANDOLPH UNION
HIGH SCHOOL
LOADING DOCK AND
PAVEMENT
REDEVELOPMENT
PROJECT

SHEET TITLE

PROPOSED
CONDITIONS PLAN

DRAWN BY DSC	DATE JULY, 2019
CHECKED BY MPH	D&K PROJECT # 125685
PROJ. ENG. CJR	D&K ARCHIVE #

SHEET NUMBER

C2

SHEET 4 OF 9

I:\1\125685_RUHS>Loading Dock & Pavement Redevelopment\Drawings\CAD\Design Plans\20190822 - Ex-Prop Conditions.dwg 7/9/2019 9:44 AM

**NOT FOR
CONSTRUCTION
BID PLANS**

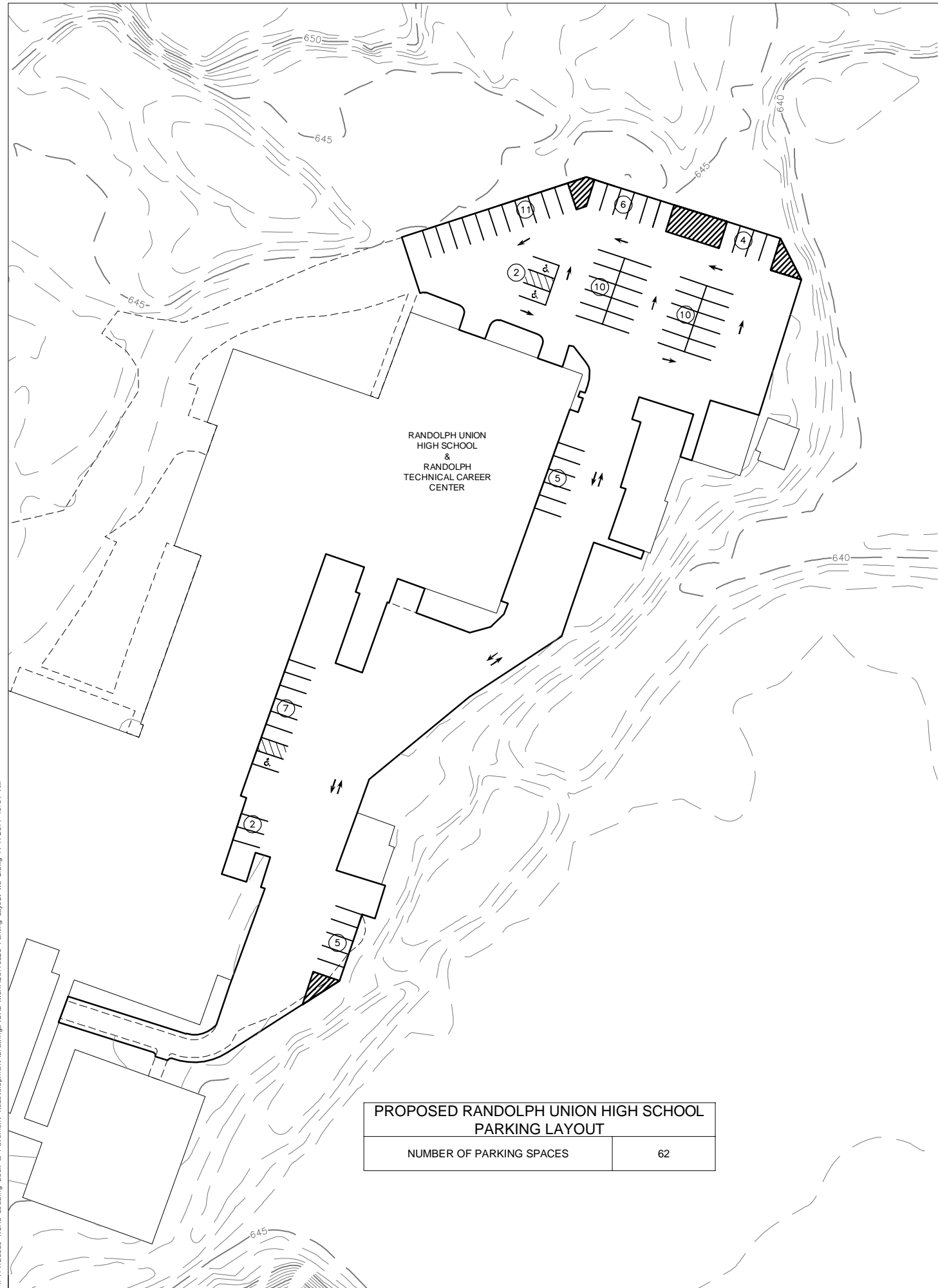

PROPOSED RANDOLPH UNION HIGH SCHOOL PARKING LAYOUT	
NUMBER OF PARKING SPACES	62

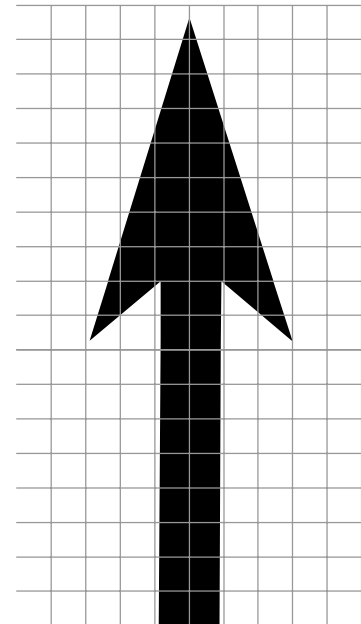

DIRECTIONAL ARROW
NOT TO SCALE

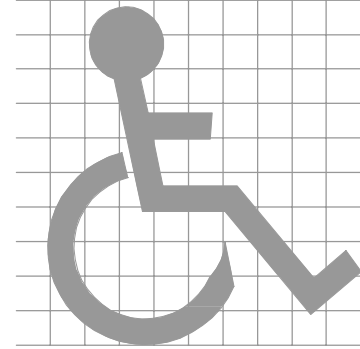

HANDICAP PAVEMENT MARKING
NOT TO SCALE

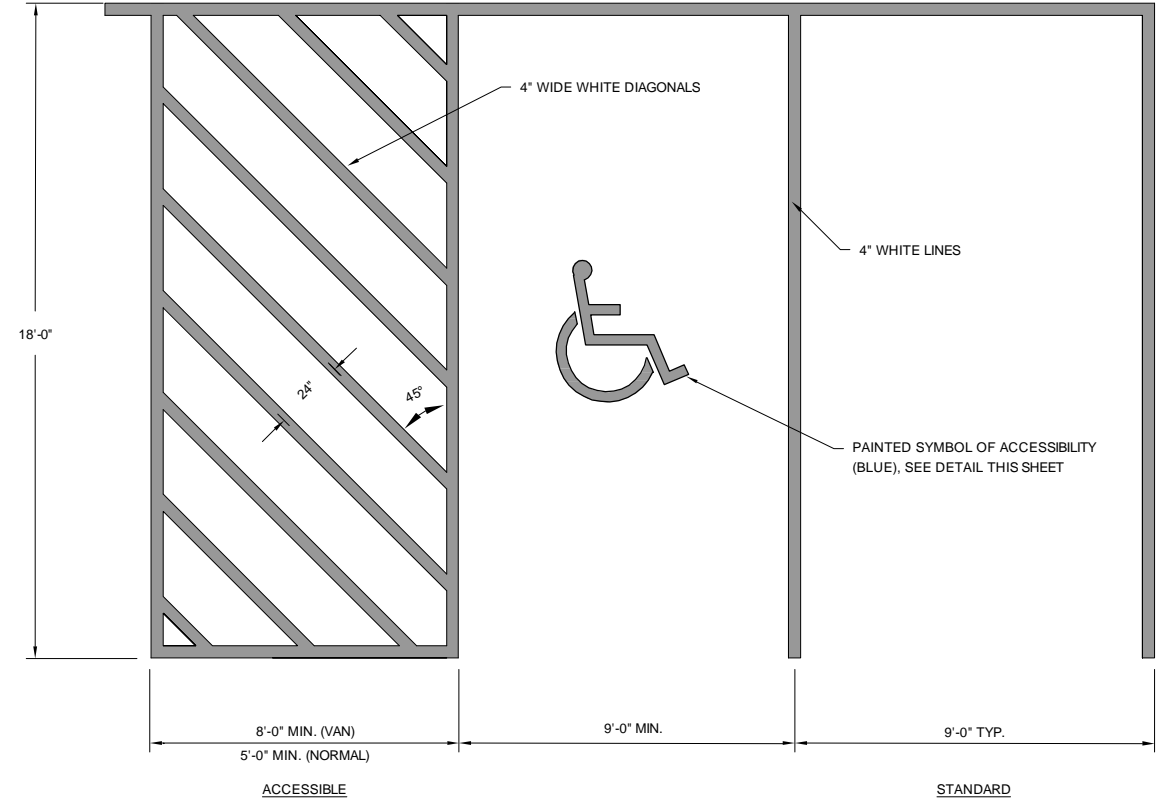

PARKING PAVEMENT MARKINGS
NOT TO SCALE

NO.	DATE	DESCRIPTION	BY	C/D

ORANGE
SOUTHWEST
SCHOOL DISTRICT
24 CENTRAL STREET
RANDOLPH, VT 05060

RANDOLPH UNION
HIGH SCHOOL
LOADING DOCK AND
PAVEMENT
REDEVELOPMENT
PROJECT

SHEET TITLE
PARKING LAYOUT

DRAWN BY DSC	DATE JULY, 2019
CHECKED BY MPH	D&K PROJECT # 125685
PROJ. ENG. CJR	D&K ARCHIVE #

SHEET NUMBER
C2A
SHEET 4A OF 9

I:\1\125685_RUHS>Loading Dock & Pavement Redevelopment\Drawings\CAD\Work\20190625 Parking Layout WS 2.dwg 7/17/2019 10:59 AM